

HAND BLOWN SHADES AVAILABLE IN: SATIN ETCHED CASÉ OPAL ON TOP AND BOTTOM  
 ETRUSCAN OVER SATIN ETCHED CLEAR ON TOP AND BOTTOM  
 SATIN ETCHED CASÉ OPAL TOP WITH SATIN ETCHED COBALT BLUE BOTTOM

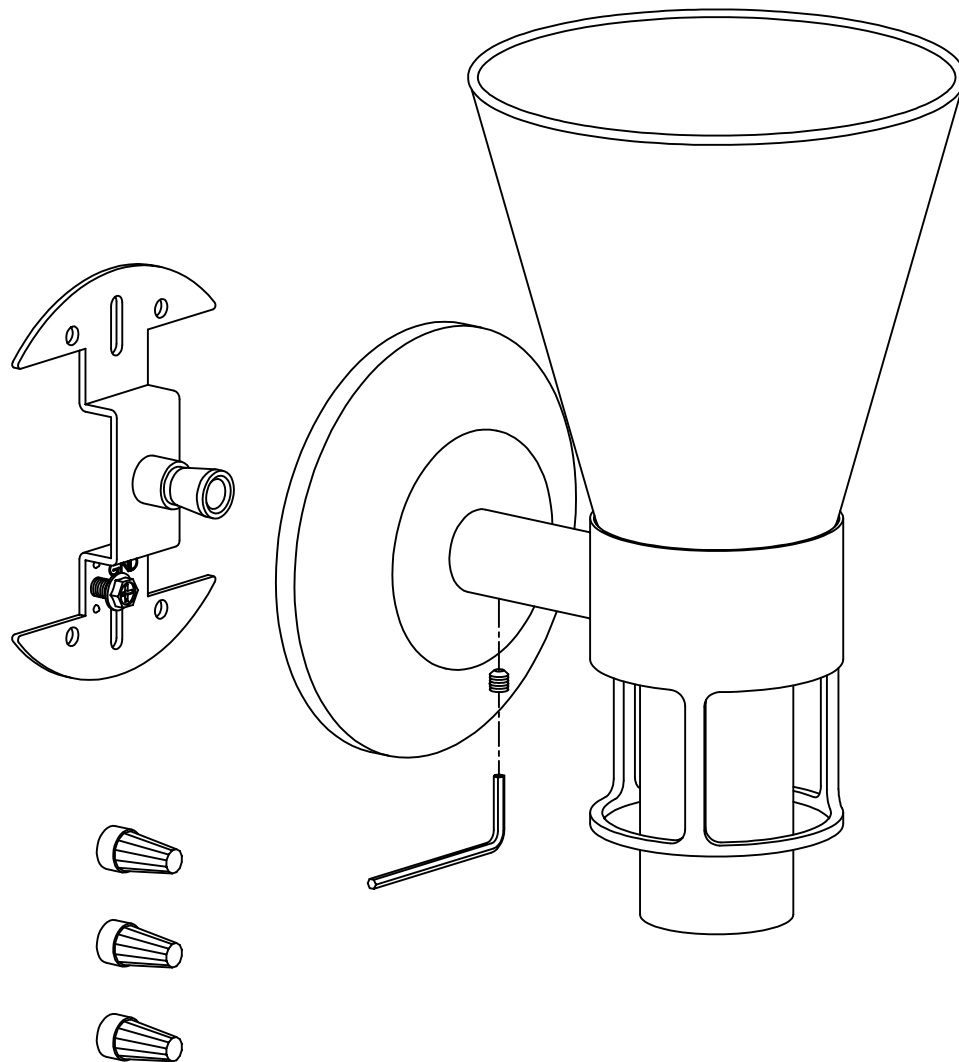

# RECOMMENDED BULBS

TOP: A15 OR A19 INCANDESCENT, 100 WATT MAXIMUM  
 BOTTOM: C7 OR E12 "CANDELABRA" BASE, 20 WATT MAXIMUM

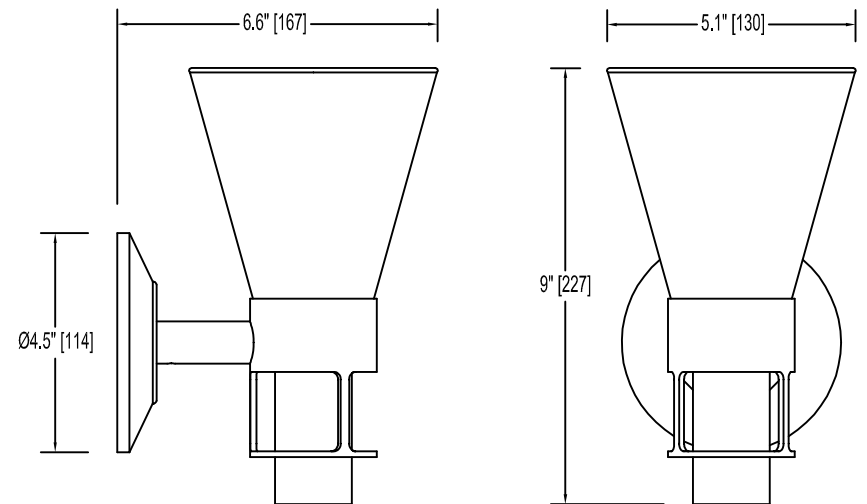

INSTALLATION NOTE: FOR SEPARATE MAIN LIGHT AND NIGHTLIGHT OPERATION, PROVIDE  
 TWO INDIVIDUALLY SWITCHED "HOT" WIRES TO LIGHT FIXTURE.

FINISHES: 3-POLISHED BRASS, 11-ANTIQUE COPPER, 26-POLISHED CHROME, POL. COPPER, MATTE CHROME, RAL9010, VERDIGRIS				GINGER
MATERIAL: VARIOUS BRASSES, STEEL, HAND BLOWN GLASS		WEIGHT: 2 LBS. 2 OZ. [1 KG.]	DESIGN: VICTOR HOERNIG	
PART NO.	1982	LIGHT		DWG.NO.
DATE: 14.MAR.00	REV. 25.MAY.01	SCALE 1:4	SYNCHRO	PD-1982